

Power supply of SZB headend



- Output voltage is additionally available from two auxiliar jacks, for connection to one or two power inserters (mast-head amplifier remote powering).
- Mains lead with bipolar plug.
- Banana jumper supplied.

MODEL		SZB-214
REF.		2250
Mains voltage	VAC	100 - 240 (50/60 Hz)
	W	120
Output voltage	VDC	+24
Max. output current	A	4.5
Operating temperature	°C	-10 ... +55
Protection level	IP	IP20



Fitting from the base-plate

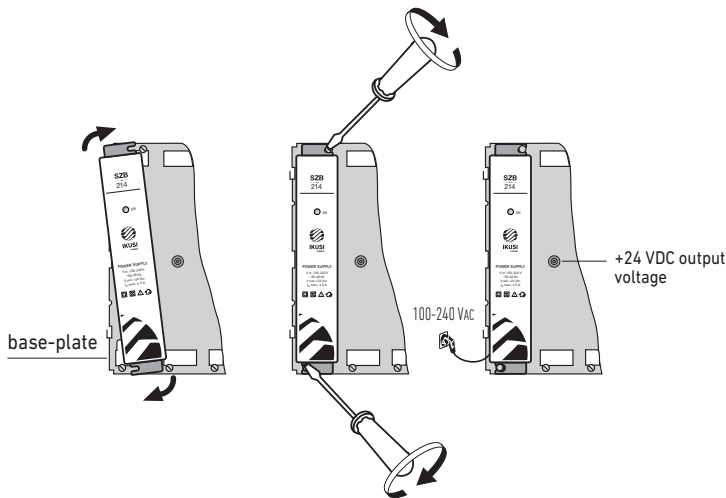

Removing from the base-plate

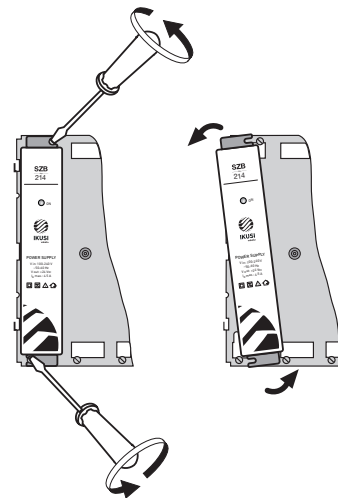

- The +24 VDC output voltage is available at the circular terminal A on the base of the module, as well as at each one of the two banana sockets B on the upper side.

NOTE: The power supply SZB-214 features soft-start: after mains connection, the +24 VDC output voltage is not available until 7 seconds later.

