

PB05

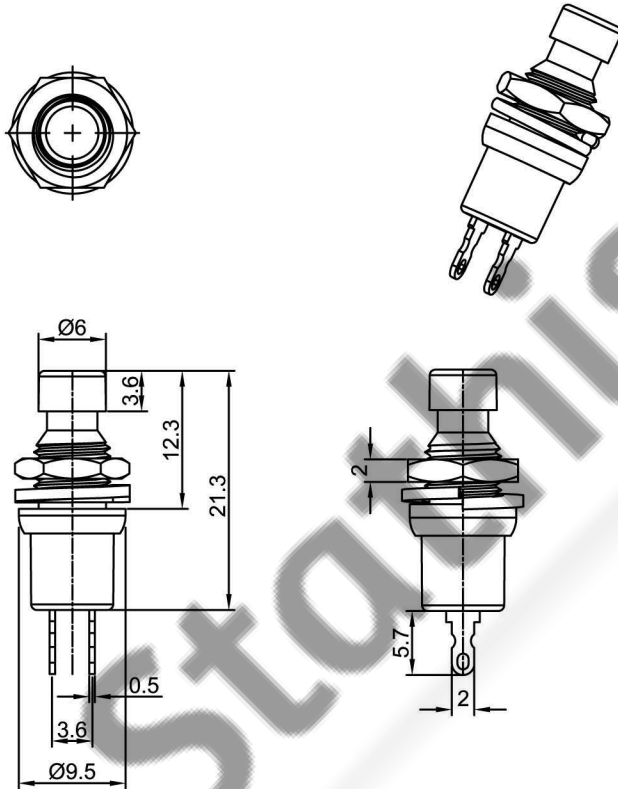

Rating: 3A 125 VAC
1.5A 250 VAC
Contact Resistance: 20mΩ Max.
Insulation Resistance: DC 500V 100MΩ Min.
Dielectric Strength: AC 1000V 1 minute
Total travel: 1.4±0.4mm
Operating Force: 200±50gf
Mechanical Life: Over 30,000 cycles
Electrical Life: Over 10,000 cycles
Operating Temperature: -20°C~+70°C
Soldering Temperature: 256°C for 5 Seconds
Function: OFF - (ON)
Welding method: Manual Soldering
(350° C±5° C, 3s±0.5s)

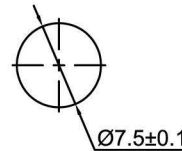

CUT-OUT



Panel Thickness: 3mm MAX.

MATERIAL:

Base: Brass, Chrome or Tin plated ;
Cap: ABS ;
Terminal: Copper, Silver or Tin plated ;
Nut: Brass, Chrome or Tin plated .

PB05-B-B
01.087.0085